

SULPHUR CREEK

RESORT, INC.

3622 SULPHUR CREEK ROAD
BURKESVILLE, KENTUCKY 42717

2017 RATES

FOR RESERVATIONS CALL
270-433-7272

Web Address: www.sulphurcreek.com

E-Mail: SCR@DUO-County.com

N36°40.340 by W085°20.251

DALE HOLLOW LAKE'S COMPLETE VACATION CENTER

CABINS RESTAURANT SHIPS STORE
HOUSEBOATS SMALL BOAT RENTALS CAMPGROUND

↔ **CABINS** ↔

Our Cabins offer the finest in leisure accommodations located on the Lake.

↔ **ALL CABINS INCLUDE:** ↔

- SHEETS AND TOWELS
- CENTRAL HEAT AND AIR
- COVERED BOAT SLIP (9½FT X 20FT)
- T.V.
- MICROWAVE OVEN
- GRILL AND PICNIC TABLE
- ONE BOAT LAUNCH PASS
- COMPLETE FURNISHINGS
- ELECTRIC DRIP COFFEE MAKER
- ELECTRIC TOASTER
- COMPLETE KITCHEN UTENSILS
- TABLEWARE
- FULL BATHROOM
- DISHWASHER

↔ **EXECUTIVE CABINS** ↔

With Additional Features

- 2 BATHS
- 3 BEDROOMS
- FIREPLACE OR PATIO
- SECLUDED
- 4 - QUEEN BEDS

↔ **PLANTATION HOUSE** ↔

Our Plantation House offers all the features of a cabin with an unequalled access and view of Dale Hollow. Each suite features a large breakfast bar, a living room, full bath and a lakeview veranda. Your second floor cathedral bedroom includes one queen size bed plus one single bed which also opens out atrium doors onto a lakeview veranda. The third floor loft contains 2 single beds.

★★★ **BOAT/RV DRY STORAGE** ★★★

- NEAR LAKE
- SECURE
- SEVERAL SITES

CABIN RATES

Rates In Season

May 25-September 10, 2017

Fall
Spring

Cabins	3 DAY	RES. DEP.	4 DAY	RES. DEP.	7 DAY	RES. DEP.	DAILY 2-MIN	RES DEP
2 Bedroom, 1 Bath-4 persons	520	300	695	300	1130	550	145	240
3 Bedroom, 1 Bath-6 persons	590	350	775	350	1275	650	165	270
3 Bedroom, 2 Bath-6 persons	710	400	945	400	1525	750	190	320
3 Bedroom, 2 Bath-8 persons	770	450	1000	450	1670	850	210	345
Plantation House-4 persons	510	300	680	300	1100	550	143	235
Ponderosa & Lodge 1	140.00 day						110	200
Lodge 2, 3, 4	99.00 day						85	150

Fishing Boats and Motors

- Boat Only (14 ft.).....\$25.00/Day
 - Boat and 15HP Motor\$60.00/Day
- Fishing boats require authorization only of \$50.00*

Pontoon Boats

- Deluxe 60HP Double Deck 90HP Deck Boat with Rest Room
 - Day \$200 Day \$250 Day \$350
- Pontoon boats require deposit only of \$50.00.*

Slips

Houseboat, Cruiser and Small Boat Slips
(covered & uncovered) available.

CAMPGROUND

- Family of four (4)
(W/E/Boat Slip\$40.00
(Some Sewer)
- Extra Persons over 12 years.....\$5.00

Check out time 10:00 A.M.
(Holidays require 3 day minimum rental.)

Holiday reservations require 3 day deposit. A 2 day deposit plus a 2 day minimum rental required in season.
See our website for campground rental policy.

CABIN RESERVATION POLICY:

1. Reservation deposit required for all units. Refer to chart.
2. No personal checks on day of arrival.
3. No Pets. You will not be allowed to enter unit with pet. A Fee of \$100.00 per day will be charged if the presence of pets is detected.
4. You will be charged for the entire time of your confirmed reservation. No refunds for late arrival or early termination.
5. If you cancel 60 days prior to arrival there is a full refund. If within the 60 days there is a partial refund if we re-rent the entire rental period. A minimum \$20.00 remarketing fee is charged.
6. State and local taxes additional, 6% s/s tax, 3% rm. tax, 1% state rm tax, rates subject to change without notice.
7. A valid credit card is required at check in for possible damages, theft, etc...

WEEKEND: FRIDAY TO MON.

APRIL

S	M	T	W	T	F	S
						1
2	3	4	5	6	7	8
9	10	11	12	13	14	15
16	17	18	19	20	21	22
23	24	25	26	27	28	29

MAY

S	M	T	W	T	F	S
	1	2	3	4	5	6
7	8	9	10	11	12	13
14	15	16	17	18	19	20
21	22	23	24	25	26	27
28	29	30	31			

JUNE

S	M	T	W	T	F	S	
					1	2	3
4	5	6	7	8	9	10	
11	12	13	14	15	16	17	
18	19	20	21	22	23	24	
25	26	27	28	29	30		

MIDWEEK: MON. TO FRI.

WEEK: STARTS ON FRI. OR MON.

JULY

S	M	T	W	T	F	S
						1
2	3	4	5	6	7	8
9	10	11	12	13	14	15
16	17	18	19	20	21	22
23	24	25	26	27	28	29
30	31					

AUGUST

S	M	T	W	T	F	S
		1	2	3	4	5
6	7	8	9	10	11	12
13	14	15	16	17	18	19
20	21	22	23	24	25	26
27	28	29	30	31		

SEPTEMBER

S	M	T	W	T	F	S
					1	2
3	4	5	6	7	8	9
10	11	12	13	14	15	16
17	18	19	20	21	22	23
24	25	26	27	28	29	30

OCTOBER

S	M	T	W	T	F	S
1	2	3	4	5	6	7
8	9	10	11	12	13	14
15	16	17	18	19	20	21
22	23	24	25	26	27	28
29	30	31				

SUPER SAVER

ECONOMY

PREMIUM

		Rental	Reservation Deposit	Rental	Reservation Deposit	Rental	Reservation Deposit
80 ft. ESCAPEDE Sleeps 12 <i>The Ultimate Escape on Dale Hollow</i> Authorization only for \$500.00	3 Night Weekend	2030	600	2540	800	2985	1000
	4 Night Midweek	2030	600	3160	800	3720	1000
	7 Night Week	3500	1000	4360	1300	5130	1700
82 ft. EXECUTIVE Sleeps 12 <i>Top of the Line In House Boating</i> Authorization only for \$500.00	3 Night Weekend	2220	700	2745	950	3230	1300
	4 Night Midweek	2220	700	3420	950	4025	1300
	7 Night Week	3820	1200	4735	1600	5570	2200
90 ft. EAGLE Sleeps 12 <i>The Best of The Fleet</i> Authorization only for \$500.00	3 Night Weekend	3740	1100	4500	1300	4800	1600
	4 Night Midweek	4840	1100	5800	1300	6200	1600
	7 Night Week	7540	2200	8570	2600	10,000	3200

CHECK-IN (ARRIVAL)

- All houseboats board at 4:00 p.m. on day of arrival
- After boarding all houseboats must leave dock (1) one hour before dark or remain moored until 7:00 a.m. the following day

* Rental Prices DO NOT include KY sales tax & gas.

CHECK-OUT (DEPARTURE)

- All houseboats must be back to dock and unloaded by 10:00 a.m. on day of departure.

Includes (1) one boat launch pass

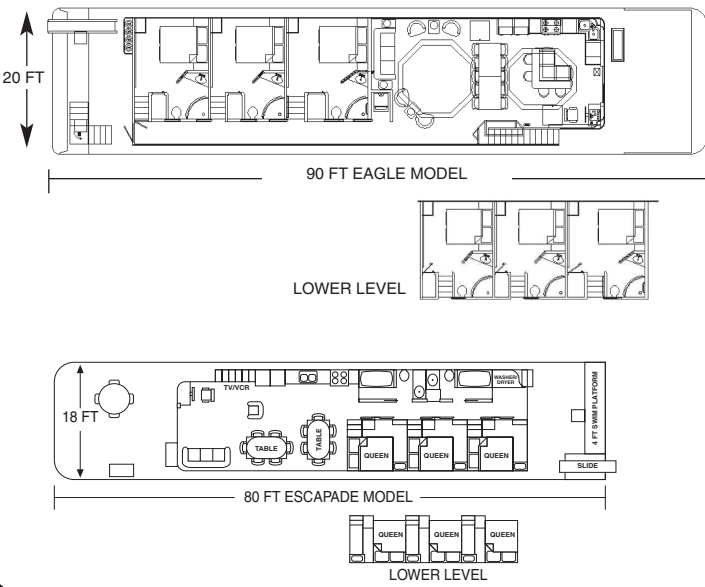

90 ft. Eagle Features:

- 3rd Level Sundeck
- 8 TV's
- 6 Full Baths
- Dishwasher

All Houseboats Feature:

- Hot Tubs
- Slides
- Bed Linens
- Washer/Dryer
- Dish Network Satellite

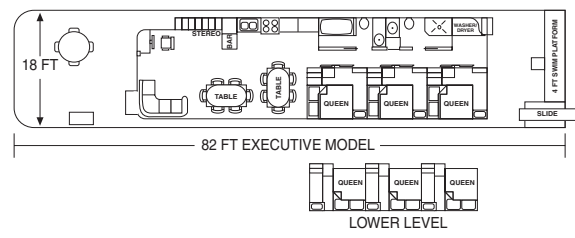

Houseboat Amenities

80 ft. Escapade
82 ft. Executive
90 ft. Eagle

	Sleeps	Bedrooms	Water Slide	Fly Bridge	Washer/Dryer	A/C Heat Water Cooled Refrigerator/Freezer	Shower/Hot Water	Bathrooms	Hot Water Heater	Heads (holding tank)	Generator	AM/FM	36" TV	Satellite TV	CD Player/DVD	Marine Radio	Microwave	El. Toaster/Coffeemaker	Gas Stove/Oven	Cooking Utensils	Tableware	Gas Grill	Hot Tub	Deck Furniture	Lounge Chairs	Large Cooler	Engines	Carpet	Pillows/Blankets	Sheets/Pillowcases
80 ft. Escapade	12	6	Y	Y	Y	2	2	2	2	1	2	2	2	Y	Y	Y	Y	Y	Y	Y	Y	Y	Y	Y	4	2	10/B	Y	Y	Y
82 ft. Executive	12	6	Y	Y	Y	3	2	6	0	2	6	2	Y	Y	Y	Y	Y	Y	Y	Y	Y	Y	Y	Y	4	2	21/0	Y	Y	Y
90 ft. Eagle	12	6	Y	Y	Y	3	2	6	0	2	6	2	Y	Y	Y	Y	Y	Y	Y	Y	Y	Y	Y	4	2	21/0	Y	Y	Y	

RENTAL POLICY

RESERVATION DEPOSIT: Houseboat rental reservations will be confirmed in writing upon receipt of your reservation deposit. The entire rental charge plus 6% KY sales tax, and the damage deposit is due prior to boarding. On the day of arrival the reservation deposit holds the boat for an 18 hour period.

PAYMENT: Mastercard, VISA, and cash are accepted for payment. Reservation deposits made by credit card will be returned as card credit. No personal checks accepted less than 30 days of arrival.

CANCELLATIONS: Full refunds are given for cancellations made in writing 60 days prior to arrival. Cancellation made less than 60 days will be charged a \$100.00 remarketing fee. Refunds are granted only if the entire rental period reserved is re-rented. Transfer of reservation deposits must be made at least 60 days prior to the original date, any changes thereafter will be charged a \$25.00 rescheduling fee for each change. Changes are made only for the same calendar year.

DAMAGE DEPOSIT: We do an authorization only for your damage deposit. We do not charge your card provided that the boat is returned clean, undamaged, and unloaded before 10:00 A.M. Central Time. A \$100.00 per hour late charge will be applied for failure to return and be unloaded. REMEMBER YOU ARE RESPONSIBLE FOR THE VESSEL AND ITS CONTENTS AND ARE ACCOUNTABLE FOR ANY AND ALL DAMAGES AND MISSING ITEMS.

REFUNDS: Refunds of payments will not be made for early termination or late arrivals. You will be charged for the amount of time of your entire reservation. Problems not reported for repair will not be considered for refunds. Marina will provide assistance for breakdowns during daylight working hours, or as quickly as possible.

RENTAL AGREEMENT: Renter will be required to sign a rental agreement and waiver prior to boarding. Renter must check in, pay, and be ready to leave Harbor at least (1 hr.) before dark or remain in harbor until morning.

NO PETS: Persons bringing pets will be refused unit.

FOR RESERVATIONS CALL (270) 433-7272